

LEGEND

- EXISTING CITY BOUNDARY ESTABLISHED BY RINCON VALLEY ANNEXATION NO. 14, ESTABLISHED BY ORDINANCE NO. 1066, FILED ON AUGUST 22, 1962 IN BOOK 90 OF MAPS AT PAGE 24, S.C.R.
- EXISTING CITY BOUNDARY ESTABLISHED BY RINCON VALLEY ANNEXATION NO. 35, ESTABLISHED BY ORDINANCE NO. 1334, FILED ON MAY 17, 1968 IN BOOK 125 OF MAPS AT PAGE 20, S.C.R.
- EXISTING CITY BOUNDARY ESTABLISHED BY NORTHEAST SANTA ROSA REORGANIZATION NO. 11-80, ESTABLISHED BY RESOLUTION NO. 15404, FILED ON DECEMBER 14, 1981 IN BOOK 329 OF MAPS AT PAGE 23, S.C.R.

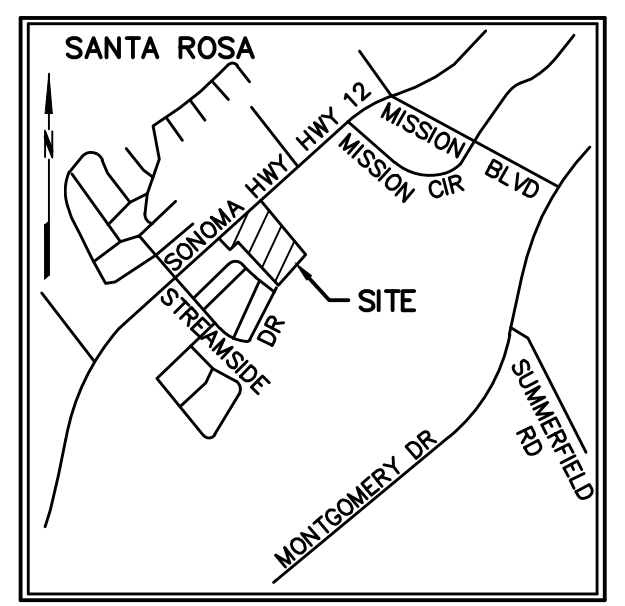
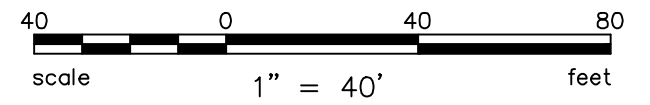

VICINITY MAP
NOT TO SCALE

NOTES

ALL DISTANCES AND DIMENSIONS ARE SHOWN IN FEET AND DECIMALS THEREOF.
ALL BEARINGS AND DISTANCES SHOWN ON THIS MAP ARE FOR INFORMATIONAL PURPOSES ONLY AND ARE NOT INTENDED TO AFFECT BOUNDARIES OF THIS ANNEXATION.

- ① LANDS OF STREAMSIDE PLACE HOMEOWNERS ASSOCIATION VACANT
APN 032-520-061
DN 2006-113666
- ② LANDS OF MESSANA RUSSELL TR & MESSANA MARTHA TR
4057 CALLOWAY DRIVE
APN 032-520-012
DN 2012-049455
- ③ LANDS OF STREAMSIDE REALTY HOLDINGS LP
4061 CALLOWAY DRIVE
APN 032-520-013
DN 2009-027730
- ④ LANDS OF STREAMSIDE REALTY HOLDINGS LP
4065 CALLOWAY DRIVE
APN 032-520-014
DN 2009-027729
- ⑤ LANDS OF STREAMSIDE REALTY HOLDINGS LP
4069 CALLOWAY DRIVE
APN 032-520-015
DN 2009-027731
- ⑥ LANDS OF STREAMSIDE REALTY HOLDINGS LP
4073 CALLOWAY DRIVE
APN 032-520-016
DN 2009-027726
- ⑦ LANDS OF STREAMSIDE REALTY HOLDINGS LP
4424 STREAMSIDE DRIVE
APN 032-520-017
DN 2009-028348
- ⑧ LANDS OF THE CITY OF SANTA ROSA VACANT
APN 032-520-059
DN 2005-182949

LAFCO'S CERTIFICATE

APPROVED BY SONOMA LOCAL AGENCY FORMATION COMMISSION IN RESOLUTION NO. _____ DATED _____.

BY: _____ DATE: _____
EXECUTIVE OFFICER

CITY ENGINEER'S CERTIFICATE

I, DAVID M. GUHIN, CITY ENGINEER OF THE CITY OF SANTA ROSA, HEREBY CERTIFY THAT THE MAP HEREON SHOWN CONFORMS TO THE REQUIREMENTS OF TITLE 4, DIVISION 1, CHAPTER 1, ARTICLE 3 OF THE GOVERNMENT CODE OF THE STATE OF CALIFORNIA AND TO THE DESCRIPTION OF THE REORGANIZATION AS ADOPTED BY SONOMA LAFCO, IN RESOLUTION NO. _____ DATED _____.

DAVID M. GUHIN
R.C.E 65663 EXPIRES 09-30-19
CITY ENGINEER, CITY OF SANTA ROSA
STATE OF CALIFORNIA

DEPUTY _____

SURVEYOR'S STATEMENT

THIS MAP HAS BEEN COMPILED UNDER MY DIRECTION.

Ralph H. Thomas
R.L.S 4760

DATE 10-16-2019

RECORDER'S CERTIFICATE

RECORDED AT THE REQUEST OF THE EXECUTIVE OFFICER OF THE SONOMA LOCAL AGENCY FORMATION COMMISSION. THIS _____ DAY OF _____, 20____, IN BOOK _____ OF MAPS, AT PAGE _____, SONOMA COUNTY RECORDS.

COUNTY RECORDER _____

DEPUTY _____

SOUTHEAST SANTA ROSA REORGANIZATION NO. 18-001
(CALLERI/AMORE REALTORS, LLC.)

INVOLVING - ANNEXATION TO THE CITY OF SANTA ROSA AND DETACHMENT FROM THE SONOMA COUNTY FIRE DISTRICT AND CSA NO. 41. MAP OF THE NEW SOUTHEAST CITY BOUNDARY AS ESTABLISHED BY LAFCO RESOLUTION NO. _____

LOCATED IN
RANCHO CABEZA DE SANTA ROSA,
CITY OF SANTA ROSA,
COUNTY OF SONOMA, STATE OF CALIFORNIA
SEPTEMBER 2019
CONTAINING 3± ACRES

BKF
ENGINEERS / SURVEYORS / PLANNERS
200 4TH ST, STE. 300 SANTA ROSA, CA 95401
(707) 583-8500 FAX: (707) 583-8539