

TOWN ENGINEER'S CERTIFICATE

I, TONI BERTOLERO, PUBLIC WORKS DIRECTOR/TOWN ENGINEER OF THE TOWN OF WINDSOR, HEREBY CERTIFY THAT THE MAP HEREON SHOWN CONFORMS TO THE REQUIREMENTS OF TITLE 4, DIVISION 1, CHAPTER 1, ARTICLE 3, OF THE GOVERNMENT CODE OF THE STATE OF CALIFORNIA AND TO THE DESCRIPTION OF THE REORGANIZATION AS ADOPTED BY SONOMA LAFCO IN RESOLUTION NO. _____ DATED _____, 20__.

BY _____ DATE _____
 TONI BERTOLERO
 PUBLIC WORKS DIRECTOR/TOWN ENGINEER
 RCE 36539

LAFCO CERTIFICATE

APPROVED BY SONOMA LOCAL AGENCY FORMATION COMMISSION IN RESOLUTION NO. _____ DATED _____, 20__.

BY _____ DATE _____
 EXECUTIVE OFFICER

NOTES

1. ALL DISTANCES AND DIMENSIONS ARE IN FEET AND DECIMALS THEREOF.
2. ALL BEARINGS AND DISTANCES SHOWN ON THIS MAP ARE FOR INFORMATIONAL PURPOSES ONLY AND ARE NOT INTENDED TO AFFECT THE BOUNDARIES OF THIS ANNEXATION.

LEGEND

- NEW ANNEXATION BOUNDARY
- - - - - EXISTING TOWN BOUNDARY PER LAFCO RESOLUTION NO. 2093, 487 MAPS 3-38
- APN ASSESSOR'S PARCEL NUMBER
- O.R. OFFICIAL RECORDS

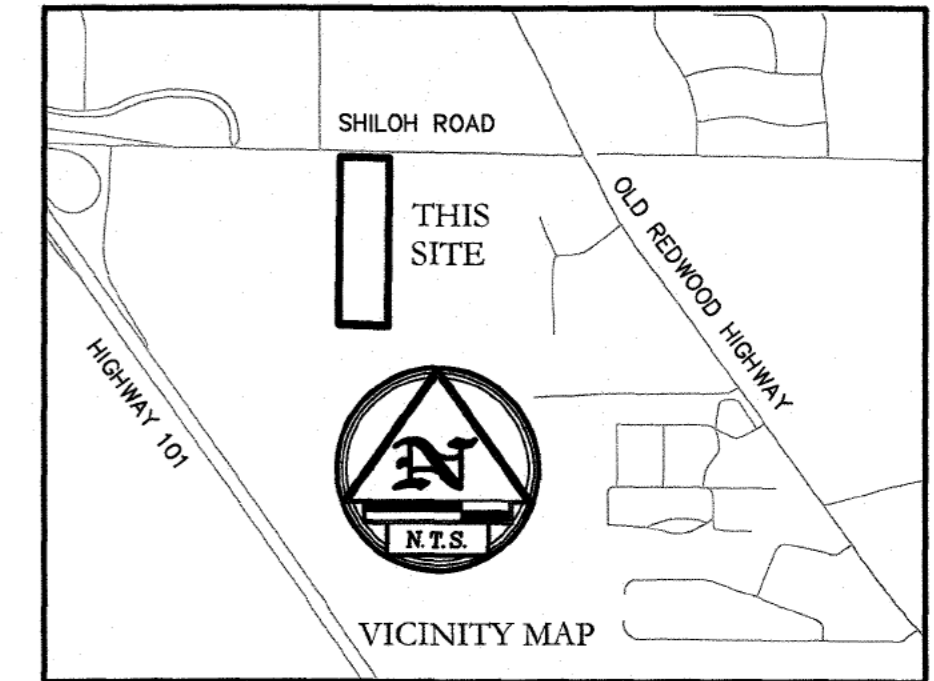

SURVEYOR'S STATEMENT

THIS MAP HAS BEEN COMPILED UNDER MY DIRECTION.

DATED: _____
 ARTHUR L. GAMBINI
 LS 4869
 EXP. 9/30/2020

RECORDER'S CERTIFICATE

RECORDED AT THE REQUEST OF THE EXECUTIVE OFFICER OF THE SONOMA LOCAL AGENCY FORMATION COMMISSION, THIS _____ DAY OF _____, 20__, IN BOOK _____ OF MAPS, AT PAGE(S) _____, SONOMA COUNTY RECORDS.

COUNTY RECORDER
 COUNTY OF SONOMA, STATE OF CALIFORNIA

DEPUTY

**REORGANIZATION
 NO. 19-3 (SOUTH SHILOH AREA)**

INVOLVING ANNEXATION TO THE TOWN OF WINDSOR AND DETACHMENT FROM COUNTY SERVICE AREA #41 (MULTI-SERVICES) CONTAINING 5.12 ACRES MORE OR LESS
 APPLICANT: LISA AND TRINI AMADOR

LYING WITHIN SECTION 19, T8N R8W, M.D.M.

COUNTY OF SONOMA STATE OF CALIFORNIA

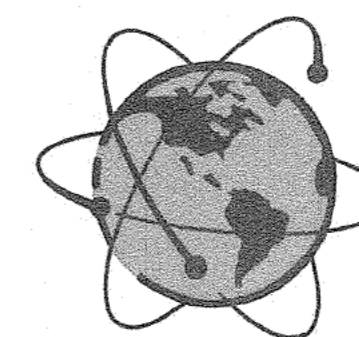

**RAY CARLSON
 AND ASSOCIATES, INC.**
 Mapping for a Better World™

SURVEYING • MAPPING • GIS • CONSULTING
 411 RUSSELL AVENUE SANTA ROSA, CALIFORNIA 95403
 (707) 528-7649 • RCMAPS.COM
 ©2019, Ray Carlson and Associates, Inc.

APN	DOCUMENT #	OWNER	SITE	TOWN
059-271-019	2014-058416	NUNES TRUST	5775 OLD REDWOOD HWY	SANTA ROSA* CA
059-271-027	2018-029583	VICINI TRUST	NONE	UNINCORP COUNTY CA
059-271-059	2018-029583	VICINI TRUST	NONE	UNINCORP COUNTY CA
059-310-038	2017-054460	GARCIA	180 SHILOH RD	UNINCORP COUNTY CA
059-310-039	2018-072766	SANDOVAL	170 SHILOH RD	UNINCORP COUNTY CA
059-310-044	2008-040566	WENDT	160 SHILOH RD	UNINCORP COUNTY CA
059-310-051	2016-074238	AMADOR TRUST	NONE	UNINCORP COUNTY CA
059-310-052	2016-074238	AMADOR TRUST	210 SHILOH ROAD	UNINCORP COUNTY CA
059-310-056	1989-046059	BAILEY	120 SHILOH RD	WINDSOR CA
059-310-057	2012-076338	HASKINS	104 SHILOH RD	UNINCORP COUNTY CA
163-171-017	1999-128344	SPOLINI	287 SHILOH RD	WINDSOR CA
163-171-021	1998-121846	POULSEN	241 SHILOH RD	WINDSOR CA
163-171-022	1998-061646	FEENAN TRUST	211 SHILOH RD	WINDSOR CA
163-171-024	1993-119417	BELEW	189 SHILOH RD	WINDSOR CA
163-171-025	2016-015222	CELLA	181 SHILOH RD	WINDSOR CA
163-171-026	2017-044800	FORD	169 SHILOH RD	WINDSOR CA
163-171-027	2013-062391	HERNANDEZ	159 SHILOH RD	WINDSOR CA
163-171-039	2016-075486	MAYER TRUST	295 SHILOH RD	WINDSOR CA

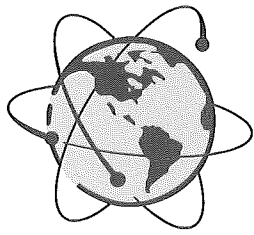

RAY CARLSON AND ASSOCIATES, INC.

Mapping for a Better World

EXHIBIT "A"

REORGANIZATION No. 19-3 (SOUTH SHILOH AREA)
INVOLVING ANNEXATION TO THE TOWN OF WINDSOR
AND DETACHMENT FROM COUNTY SERVICE AREA
No. 41 CONTAINING 5.12 ACRES MORE OR LESS
LYING WITHIN A PORTION OF SECTION 19
TOWNSHIP 8 NORTH, RANGE 8 WEST, MOUNT DIABLO BASE AND
MERIDIAN

Prepared by Ray Carlson and Associates, Inc. on July 10, 2019

All that certain real property in the County of Sonoma, State of California, being more particularly described as follows:

The **Point of Beginning** being the intersection of the south line of Shiloh Road with the east boundary of the Town of Windsor, located east of U.S. highway 101 as approved by Sonoma Local Agency Formation Commission per Resolution Number 2093 on June 13, 1991 and as shown on that map entitled "Reorganization Involving the Incorporation of the Town of Windsor" filed in Book 487 of Maps at Pages 3 through 38, Sonoma County Records, said intersection being identified as the angle point common to courses "104" and "105" on said map; thence along said existing boundary of the Town of Windsor, South 00 degrees 34 minutes 57 seconds West 869.54 feet, more or less to the intersection of said existing boundary of the Town of Windsor and the southerly boundary of the lands of Jose Trinidad Amador 111 and Lisa Royce Amador, Trustees of the Jose Trinidad Amador 111 and Lisa Royce Amador Revocable Trust dated September 30, 2002 as described in that Grant Deed recorded as Document Number 2016-074238 of Official Records, Sonoma County Records; thence along last said southerly boundary South 88 degrees 29 minutes 24 seconds East 255.88 feet, more or less to the southeast corner of said lands of Amador; thence along the easterly line of last said lands North 00 degrees 34 minutes 57 seconds East 872.90 feet, more or less

to the northeast corner of said lands of Amador and the intersection with the existing boundary of the Town of Windsor also being the south line of Shiloh Road along said course "104"; thence along said south line and the north line of said lands of Amador North 89 degrees 14 minutes 34 seconds West 255.85 feet, more or less to the **Point of Beginning**.

Assessor's Parcel Numbers: 059-310-051 and 059-310-052

All bearings and distances shown in this boundary description are for informational purposes only and are not intended to affect the boundaries of this annexation.

END OF DESCRIPTION

This description is based upon record data only.
Prepared by Ray Carlson and Associates, Inc.



JULY 10, 2019
Date

